



LED Important Safety Instructions

READ AND FOLLOW ALL SAFETY INSTRUCTIONS! SAVE THESE INSTRUCTIONS AND DELIVER TO OWNER AFTER INSTALLATION

- To reduce the risk of death, personal injury or property damage from fire, electric shock, falling parts, cuts/abrasions, and other hazards please read all warnings and instructions included with and on the fixture box and all fixture labels.
- Before installing, servicing, or performing routine maintenance upon this equipment, follow these general precautions.
- Installation and service of luminaires should be performed by a **qualified licensed electrician**.
- Maintenance of the luminaires should be performed by person(s) familiar with the luminaires' construction and operation and any hazards involved. Regular fixture maintenance programs are recommended.
- It will occasionally be necessary to clean the outside of the refractor/lens. Frequency of cleaning will depend on ambient dirt level and minimum light output which is acceptable to user. Refractor/lens should be washed in a solution of warm water and any mild, non-abrasive household detergent, rinsed with clean water and wiped dry. Should optical assembly become dirty on the inside, wipe refractor/lens and clean in above manner, replacing damaged gaskets as necessary.
- **DO NOT INSTALL DAMAGED PRODUCT!** This luminaire has been properly packed so that no parts should have been damaged during transit. Inspect to confirm. Any part damaged or broken during or after assembly should be replaced.
- Recycle: For information on how to recycle LED electronic products, please visit www.epa.gov.
- These instructions do not purport to cover all details or variations in equipment nor to provide every possible contingency to meet in connection with installation, operation, or maintenance. Should further information be desired or should particular problems arise which are not covered sufficiently for the purchaser's or owner's purposes, this matter should be referred to Acuity Brands Lighting, Inc.



WARNING: RISK OF ELECTRIC SHOCK

- ✓ Disconnect or turn off power before installation or servicing.
- ✓ Verify that supply voltage is correct by comparing it with the luminaire label information.
- ✓ Make all electrical and grounded connections in accordance with the National Electrical Code (NEC) and any applicable local code requirements.
- ✓ All wiring connections should be capped with UL approved recognized wire connectors.



WARNING: RISK OF BURN

- ✓ Allow lamp/fixture to cool before handling. Do not touch enclosure or light source.
- ✓ Do not exceed maximum wattage marked on luminaire label.
- ✓ Follow all manufacturer's warnings, recommendations and restrictions for: driver type, burning position, mounting locations/methods, replacement and recycling.



CAUTION: RISK OF INJURY

- ✓ Wear gloves and safety glasses at all times when removing luminaire from carton, installing, servicing or performing maintenance.
- ✓ Avoid direct eye exposure to the light source while it is on.



CAUTION: RISK OF FIRE

- ✓ Keep combustible and other materials that can burn, away from lamp/lens.
- ✓ Do not operate in close proximity to persons, combustible materials or substances affected by heat or drying.

Always read the fixtures complete installation instructions prior to installation for any additional fixture specific warnings. Please see product specific installation instructions for additional warnings or any applicable FCC or other regulatory statements.

Failure to follow any of these instructions could void product warranties. For a complete listing of product Terms and Conditions, please visit www.acuitybrands.com.

LED Important Safety Instructions



CAUTION: RISK OF PRODUCT DAMAGE

- ✓ Never connect components under load.
- ✓ Do not mount or support these fixtures in a manner that can cut the outer jacket or damage wire insulation.
- ✓ Controls for dimming, auto-sensing, or remote control of a luminaire that are not factory-wired to the luminaire must be checked for compatibility with the luminaire prior to installation. LED fixtures must be powered directly off a switched circuit.
- ✓ Unless individual product specifications deem otherwise: Do not restrict fixture ventilation. Allow for some volume of airspace around fixture. Avoid covering LED fixtures with insulation, foam, or other material that will prevent convection or conduction cooling.
- ✓ Unless individual product specifications deem otherwise: Do not exceed fixtures maximum ambient temperature.
- ✓ Only use fixture in its intended location.
- ✓ LED products are Polarity Sensitive. Ensure proper Polarity before installation.
- ✓ Electrostatic Discharge (ESD): ESD can damage LED fixtures. Personal grounding equipment must be worn during all installation or servicing of the unit.
- ✓ Do not touch individual electrical components as this can cause ESD, shorten lamp life, or alter performance.
- ✓ Some components inside the fixture may not be serviceable. In the unlikely event your unit may require service, stop using the unit immediately and contact an ABL representative for assistance.
- ✓ Always read the fixtures complete installation instructions prior to installation for any additional fixture specific warnings.
- ✓ Always ensure that the electrical distribution system is up to NEC (and any applicable local code) requirements.
- ✓ Verify that power distribution system has proper grounding. Lack of proper earth ground can lead to fixture failure and may void warranty.

Choose either Part 15 OR Part 18 and move to Page 3 Installation Instructions under Delivery. Outdoor will always use Part 15.

All luminaires that contain electronic devices that generate frequencies above 9kHz from any component within the luminaire comply with Part 15 of the FCC Rules. Operation is subject to the following two conditions:

- (1) This device may not cause harmful interference
- (2) This device must accept any interference received, including interference that may cause undesired operation

This device complies with Part 18 of the FCC Rules but may cause interference with cordless and cell phones, radios, televisions, and other electronic devices. To correct the problem, move the device away from the luminaire or plug into a different outlet. This product may cause interference to radio equipment and should not be installed near maritime safety communications equipment or other critical navigation or communications equipment operating between 0.45-30MHz.

Always read the fixtures complete installation instructions prior to installation for any additional fixture specific warnings. Please see product specific installation instructions for additional warnings or any applicable FCC or other regulatory statements.

**Failure to follow any of these instructions could void product warranties.
For a complete listing of product Terms and Conditions, please visit www.acuitybrands.com.**

Aculux®	Distech Controls™	Healthcare Lighting®	Juno®	nLight®
AEL®	DTL®	Holophane®	Lithonia Lighting®	Peerless®
aLight	eldoLED®	Hydrel®	Luminaire LED	Reloc®
Atrius®	Euerka	Indy™	Luminis®	Sensor Switch®
Cyclone	Gotham®	IOTA®	Mark Architectural Lighting™	Sunoptics®

Acuity Brands Lighting, Inc. assumes no responsibility for claims arising out of improper or careless installation or handling of its products.

Assist Medical Panel NAMP

INSTALLATION INSTRUCTIONS

912-00533-001

REV. B

10/11/2024

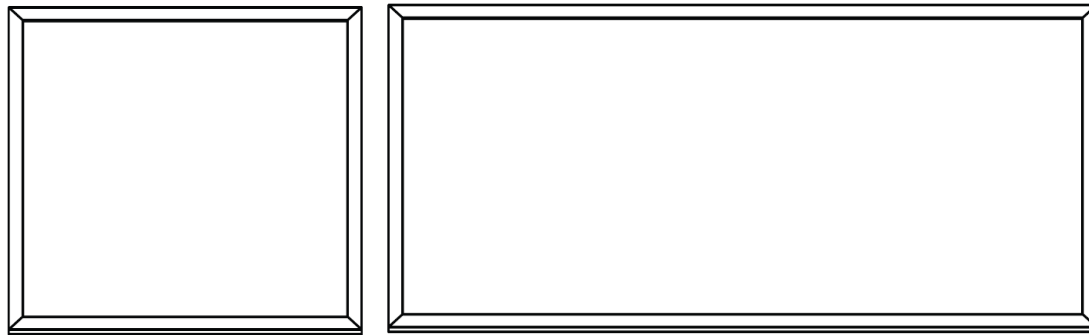

SAVE THESE INSTRUCTIONS

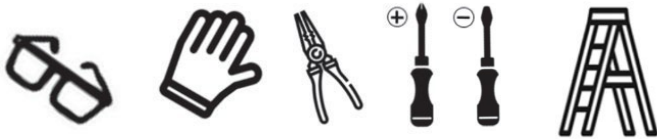

TOOLS REQUIRED FOR INSTALLATION *(by others)*

- Safety Glasses
- Protective Gloves
- Wire Strippers
- Philips Screwdriver
- Flat Blade Screwdriver
- Philips Screwdriver

5-YEAR LIMITED PRODUCT WARRANTY

Visit www.acuitybrands.com to view the terms and conditions of your Acuity Brands Lighting, Inc. limited warranty.

PRIOR TO INSTALLATION

Date Installed: _____

- Protect yourself. Read and familiarize yourself with the instructions before starting installation. Save them for future reference.
- Turn off electricity at the breaker panel or fuse box and follow National Electrical Code regulations and applicable local building codes.

Assist Medical Panel NAMP

INSTALLATION INSTRUCTIONS

912-00533-001

REV. B

10/11/2024

A. General Identification.....	Page 2
B. Wiring installation.....	Pages 3 - 5
C. Mounting.....	Page 6
D. Controls/Options:.....	Page 7

A. General Identification of Assist Medical Panel NAMP:

THIS PRODUCT MUST BE INSTALLED IN ACCORDANCE WITH THE APPLICABLE INSTALLATION CODE BY A PERSON FAMILIAR WITH THE CONSTRUCTION AND OPERATION OF THE PRODUCT AND THE HAZARDS INVOLVED

****Caution: MAKE SURE LUMINAIRE IS MOUNTED TO A SECURE STRUCTURE. USE APPROPRIATE MOUNTING HARDWARE TO INSTALL FIXTURE RATED FOR YOUR APPLICATION. FAILURE TO MOUNT FIXTURE CORRECTLY COULD RESULT IN SERIOUS INJURY.**

ABOVE CEILING ACCESS REQUIRED

NOTE: Illustrations are used for reference only and can differ slightly from the actual fixture being installed.

Key components are represented as accurately as possible.

Please see the specification sheet for description of orderable options.

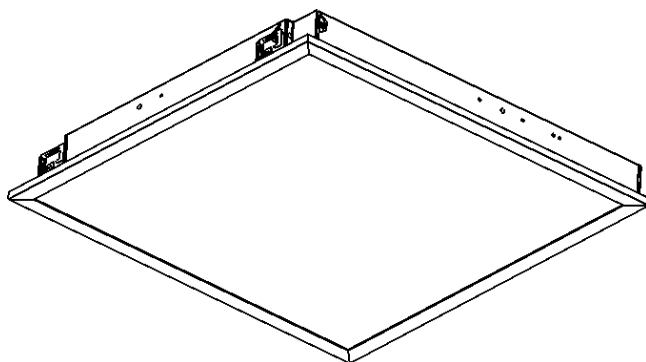

FIG 1: FRONT OF FIXTURE

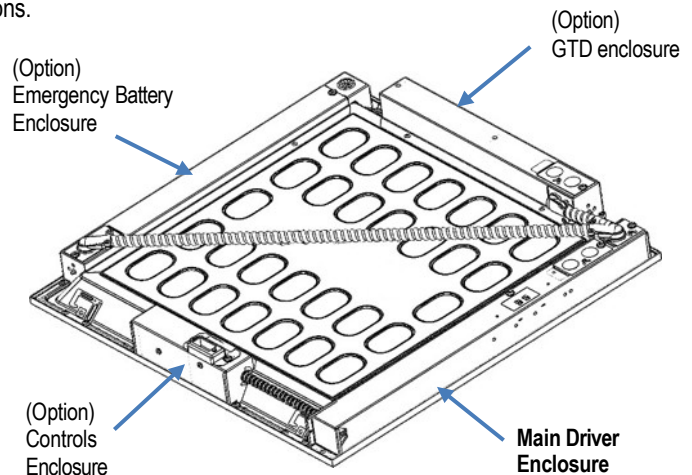
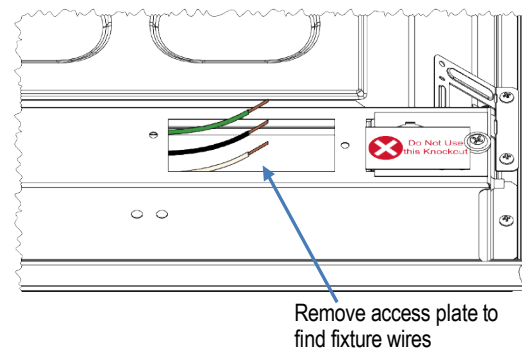
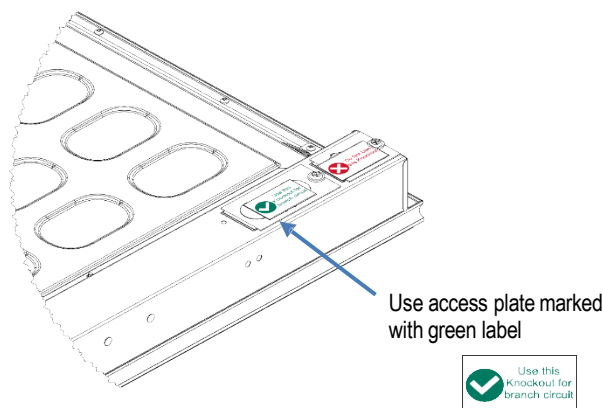

FIG 2: BACK OF FIXTURE

ACCESS PLATE:



B. Wiring:

1. Using a screwdriver (not supplied), remove access plate as shown in Figures 3 & 4, with grid power OFF make electrical connections from supply and properly ground as local codes dictate. See Figure 5. For EXAM enabled luminaires, general and exam line in shall be on the same circuit.
 - a. GREEN wire – Ground
 - b. WHITE wire – Neutral line in
 - c. BLACK wire – Hot line in / Hot line in (general mode)
 - d. ORANGE wire – Hot line in (exam mode)
2. If the dimming leads aren't being used, cap them off (if not already done).
Dimming leads are for low voltage dimming only.
 - a. PURPLE wire – 0-10V (+) (general mode) (can be capped off if not in use)
 - b. PINK wire – 0-10V (-) (general mode) (can be capped off if not in use)
 - c. YELLOW wire – 0-10V (+) (exam mode) (can be capped off if not in use)
 - d. BROWN wire – 0-10V (-) (exam mode) (can be capped off if not in use)
3. Reinstall access plate with screwdriver.

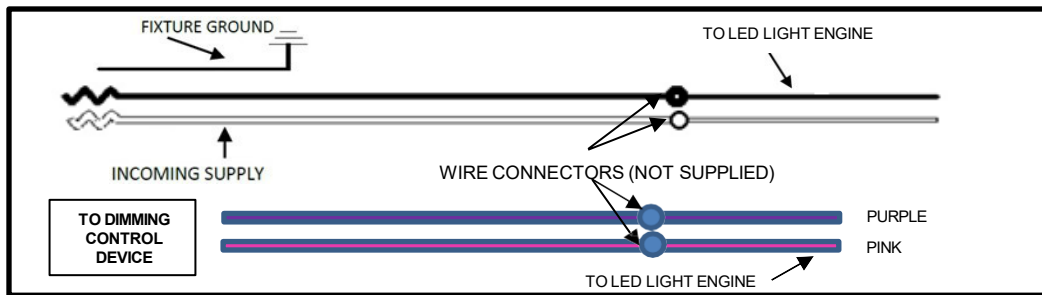
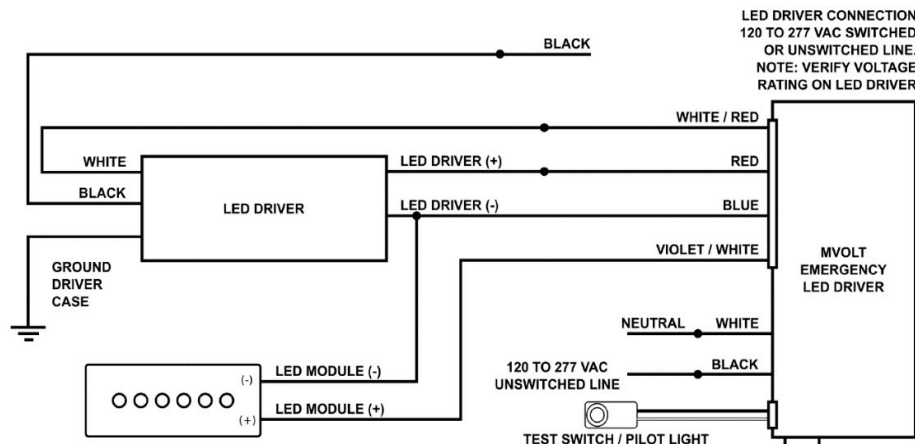

FIG 5: WIRING DIAGRAM

4. (BATTERY OPTION WITH NX OPTION) If fixture includes **factory installed emergency battery**. See Figure 6.
 - a. GREEN wire – Ground
 - b. WHITE wire – Shared Neutral line in
 - c. BLACK wire – Switched Hot line in
 - d. Labeled BLACK wire – Unswitched Hot line in to charge emergency battery
 - e. TEST SWITCH – Can be mounted in adjacent ceiling tile with included face plate and junction box (not included)

FIG 6: FACTORY BATTERY WIRING DIAGRAM



B. Wiring Continued:

5. (BATTERY OPTION WITH EXAM ZT OPTION) If fixture includes **factory installed emergency battery**.
See Figure 7.

- GREEN wire – Ground
- WHITE wire – Shared Neutral line in
- BLACK wire – Switched Hot line in
- Labeled BLACK wire – Unswitched Hot line in to charge emergency battery
- TEST SWITCH – Can be mounted in adjacent ceiling tile with included face plate and junction box (not included)

Note: The emergency battery will only energize the general mode LEDs when in emergency mode (normal power removed). It will not be possible to control the dimming or exam mode while in emergency mode.

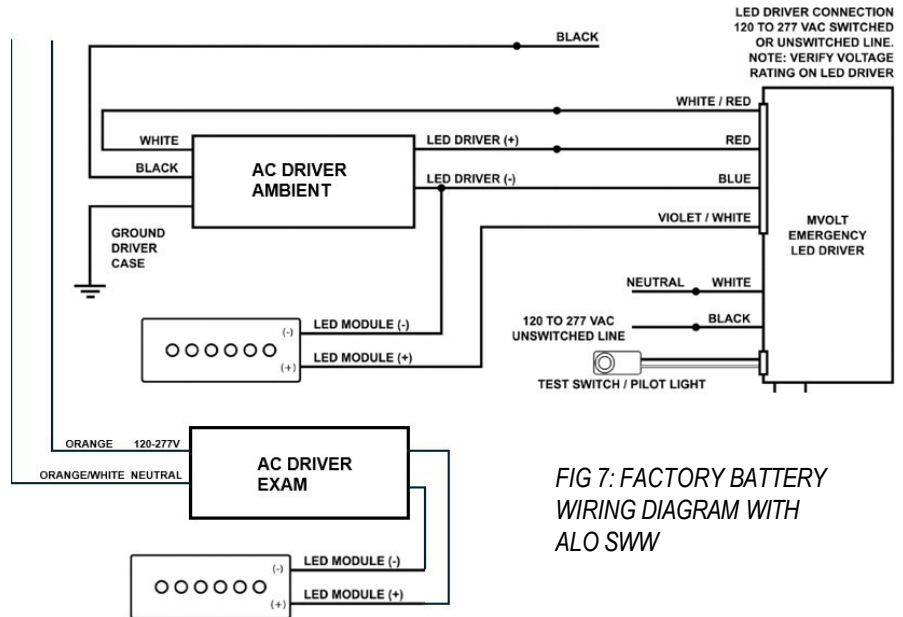

FIG 7: FACTORY BATTERY WIRING DIAGRAM WITH ALO SWW

6. (GTD OPTION) For use with generator system. See Figure 8.

At GTD Enclosure Access Plate:

- BLUE wire – Normal power, switched
- BLACK wire – Normal power, unswitched
- WHITE wire – Normal power neutral
- RED wire – Emergency power
- RED/WHITE wire – Emergency power common

At Main Driver Encloser Access Plate:

- PURPLE and PINK wires - 0-10V dimming wires, if no other controls

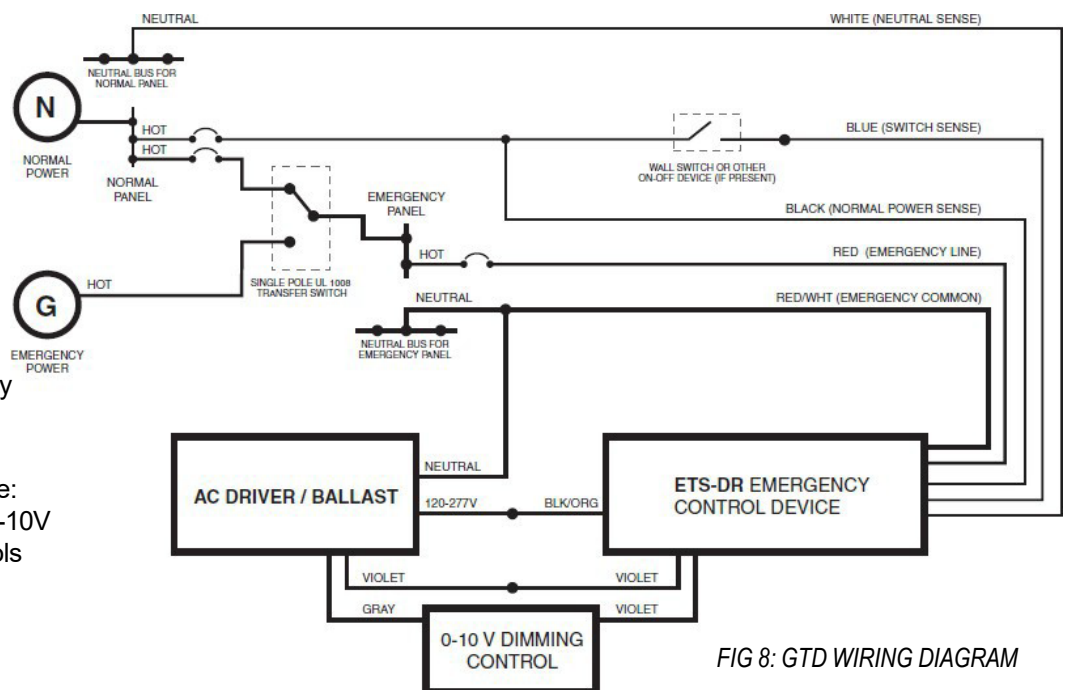

FIG 8: GTD WIRING DIAGRAM

B. Wiring Continued:

7. (GTD OPTION WITH EXAM ZT OPTION)

For use with generator system. See Figure 9.

Note: The emergency generator power battery will only energize the general mode LEDs when in emergency mode (normal power removed). It will not be possible to control the dimming or exam

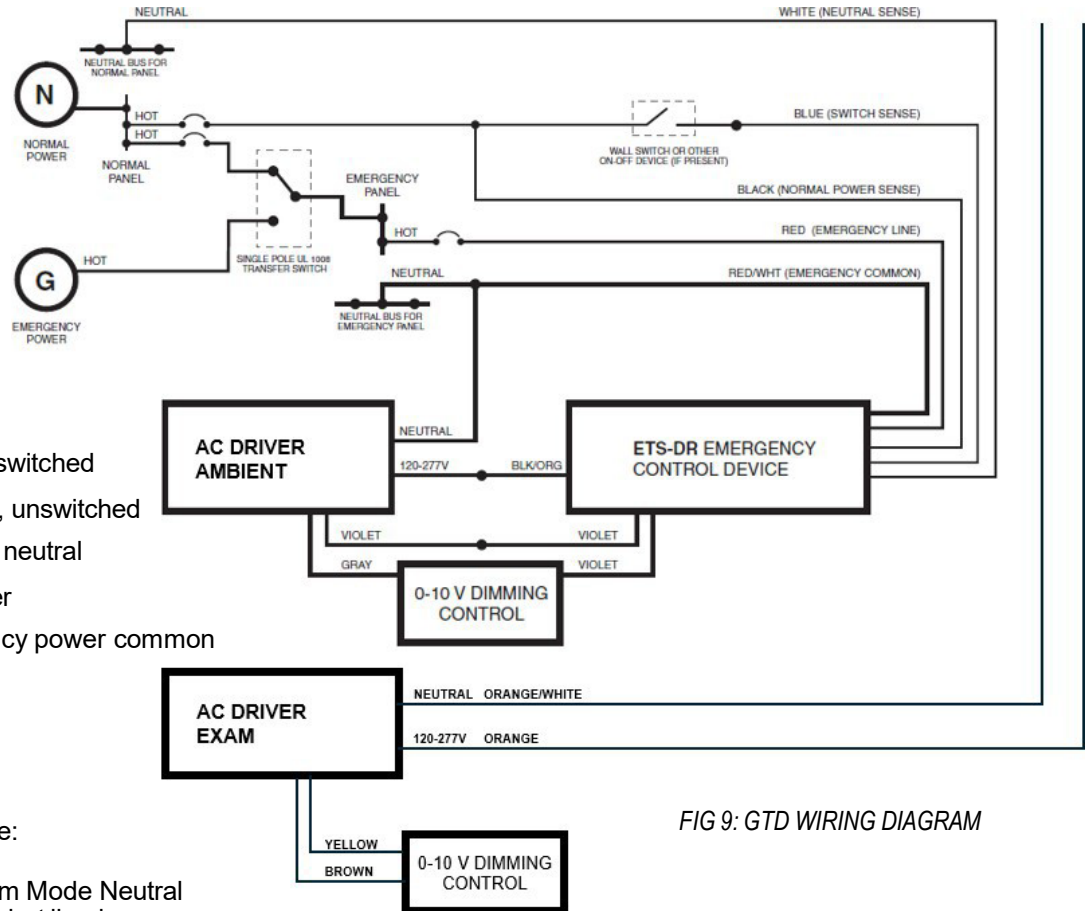

FIG 9: GTD WIRING DIAGRAM

At GTD Enclosure Access Plate:

- BLUE wire – Normal power, switched
- BLACK wire – Normal power, unswitched
- WHITE wire – Normal power neutral
- RED wire – Emergency power
- RED/WHITE wire – Emergency power common

At Main Driver Encloser Access Plate:

- GREEN wire – Ground
- ORANGE/WHITE wire – Exam Mode Neutral
- ORANGE wire – Exam mode hot line in
- PURPLE and PINK wires - 0-10V dimming wires ambient mode
- YELLOW and BROWN wires - 0-10V dimming wires exam mode

C. Mounting:

NOTE: Refrain from bending the T-Grid clips multiple times prior to installation to prevent damage to clip.

1) For mounting to T-Grid structure:

- Place the fixture in the appropriate T-Grid ceiling structure. See Figure 9.
- From above ceiling, bend the attached T-Grid clips over the T-Grid ceiling on all 4 corners to secure the fixture to the T- Grid. See Figure 10.

2) For suspension mounting (or additional T-Grid support):

- Use hanger wire holes at all 4 corners and appropriately rated hanging cables (not included) to suspend fixture. See figure 11.

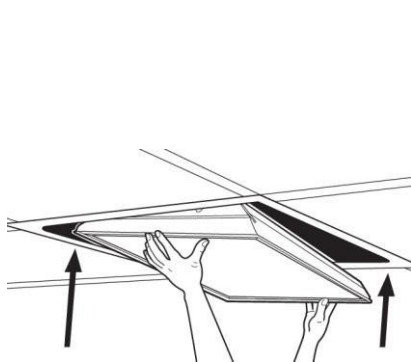

FIG. 9: CEILING INSTALLATION

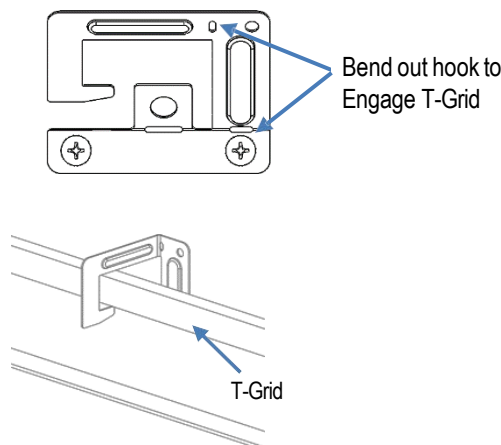

FIG. 10: T-GRID MOUNTING

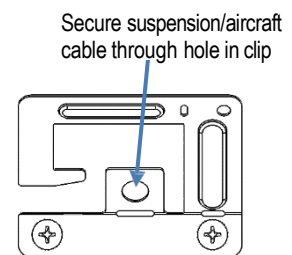

FIG. 11: SUSPENSION MOUNING

3) (ACCESSORY LATC OPTION) – BEFORE INSTALLING IN CEILING

- Using hand tools only (NO POWER TOOLS), remove the two screws holding each of the T-Grid clips to the fixture frame. (All four locations on fixture)
- Remove the T-Grid clip and replace with the LATC adapter. See Figure 12.
- Using the two screws removed in Step a., hand tighten screws to secure LATC adapter to fixture frame. Taking care not to strip threads.
- Once fixture is in T-Grid, attach LATC clips to LATC Adapter using screws provided. (Use LATC clips at all 4 locations). See Figure 13.



FIG. 12: SWAPPING T-GRID CLIP FOR LATC ADAPTER

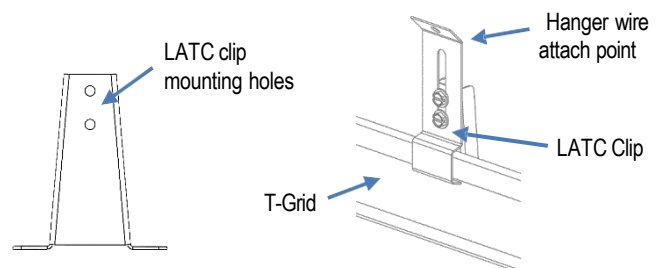

FIG. 13: ATTACHING LATC CLIPS TO T-GRID

D. Controls/Options:

1) (STANDARD) 0-10V DIMMING

- See WIRING section (page 4) for connection details
- For use with low voltage 0-10V controls (wall dimmers, remote occupancy sensors, or other devices) – not supplied.

2) (OPTION) NLIGHT CONTROLS - WIRED

- Make connections between fixtures, and to control devices, using CAT5e cables. Connection point on fixture is located on the back of the fixture at the controls enclosure. See Figure 15.
- Fixtures with emergency devices (Battery or GTD), or ordered with NLIGHTEM, will be indicated with a red control device. These fixtures may require additional components (not provided, see nLight® Wired Networked Lighting Controls Platform) to provide power to the control circuit.

FIG. 15: NLIGHT CONTROLS CONNECTION

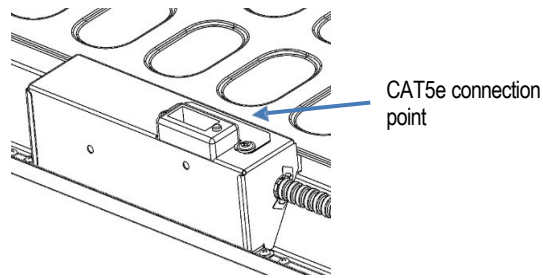

3) (OPTION) NLTAIR2 CONTROLS - WIRELESS

- For NLTAIR2 controls without an integrated sensor, the wireless radio antenna requires assembly to the fixture. The antenna will be found sitting in a recess in the controls enclosure. See Figure 16.
- Remove the antenna and thread it onto the exposed threaded post sticking out of the controls enclosure. See Figure 16. Tighten by hand until snug, **DO NOT USE A WRENCH OR POWER TOOLS**. Overtightening could damage internal wiring.
- If external antenna is not assembled to fixture, wireless communication to fixture will not be possible.

FIG. 16: NLTAIR2 ANTENNA LOCATION

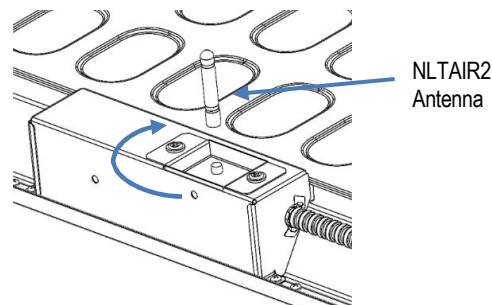

- Please see [nLight® AIR Wireless Networked Lighting Controls](#) for commissioning and additional information.